



PHQ Global

Taking Mines to the Next Level!



C2 1175 Appleby Line, Burlington Ontario Canada L7L 5H9
Phone: (905) 332-3271 Fax: (905) 332-9497 Toll: (800) 267-2082
Website: www.phqglobal.com

Column Bars & Clamps

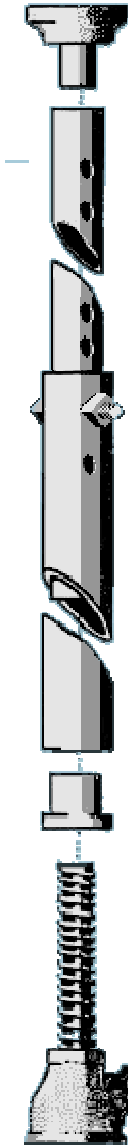

BB9600

Extension 7' – 11'

Column Bar c/w

Ratchet Jack

**COL508CA
Bar Clamp**

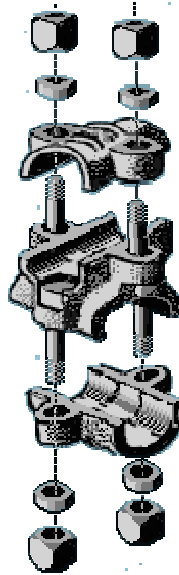

Column Bars and Clamps

**COL606X
Swing Dump Clamp**

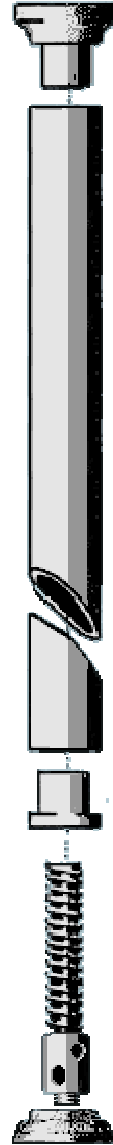
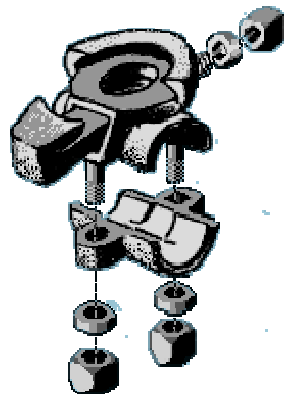

BB9800

Column Bar

Manual Screw



C2 1175 Appleby Line, Burlington Ontario Canada L7L 5H9
Phone: (905) 332-3271 Fax: (905) 332-9497 Toll: (800) 267-2082
Website: www.phqglobal.com

TOP CAP PRECISION MACHINED TO THE INSIDE DIAM OF THE INNER TUBE AND WELDED TO FIT SQUARELY ON TUBE.

INNER COLUMN BAR FROM SEAMLESS THICK WALL ALLOY STEEL TUBING FOR LONGER LIFE AND PRECISION FIT TO OUTER BAR, GIVES SMOOTH SLIDING AND RIGIDITY AT MAXIMUM EXTENSION.

ONE INCH DIAM HIGH ALLOY BOLT AND COLUMN NUT QUICKLY AND POSITIVELY HOLDS THE INNER EXTENSION TUBE AT VARIED HEIGHTS BETWEEN SEVEN AND ELEVEN FEET. THIS "THROUGH" BOLT LOCKS BOTH TUBES FROM TURNING.

OUTER COLUMN BAR FROM SEAMLESS THICK WALL ALLOY STEEL TUBING FOR LONGER LIFE AND PRECISION FIT TO INNER BAR, GIVES SMOOTH SLIDING AND RIGIDITY AT MAXIMUM EXTENSION. PLUG WELDED ABOVE SCREW TRAVEL KEEPS THE JACKSCREW CLEAN.

HIGH ALLOY COLUMN JACKSCREW NUT PRECISION MACHINED TO FIT INSIDE DIAMETER OF THE OUTER TUBE AND WELDED TO FIT SQUARELY ON TUBE.

JACKSCREW MADE FROM HIGH ALLOY STEEL. RUGGED "BOX" TYPE THREAD GIVES STRENGTH AND LONG WEAR.

A RUGGED AND DEPENDABLE RATCHET TYPE JACKBAR FOR EASY APPLICATION OF MAXIMUM PRESSURE REQUIRED.

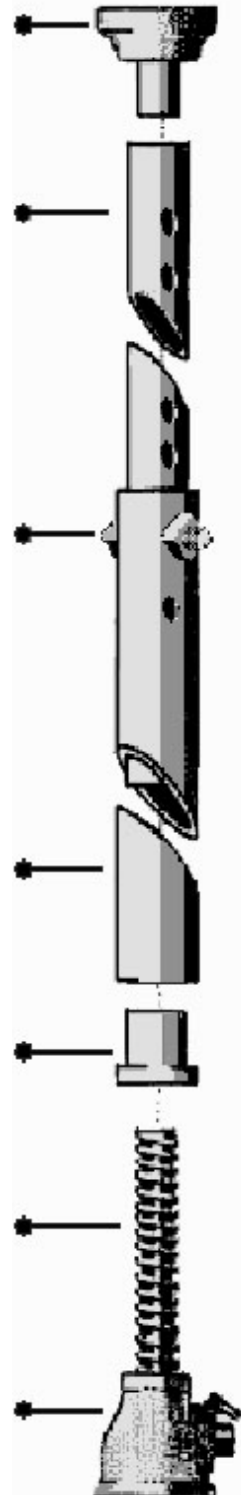

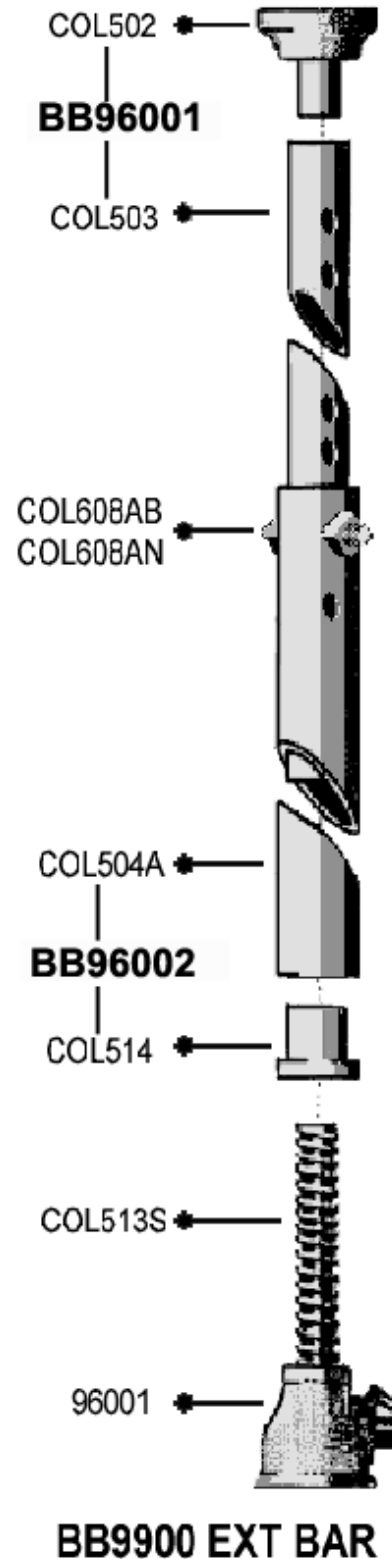
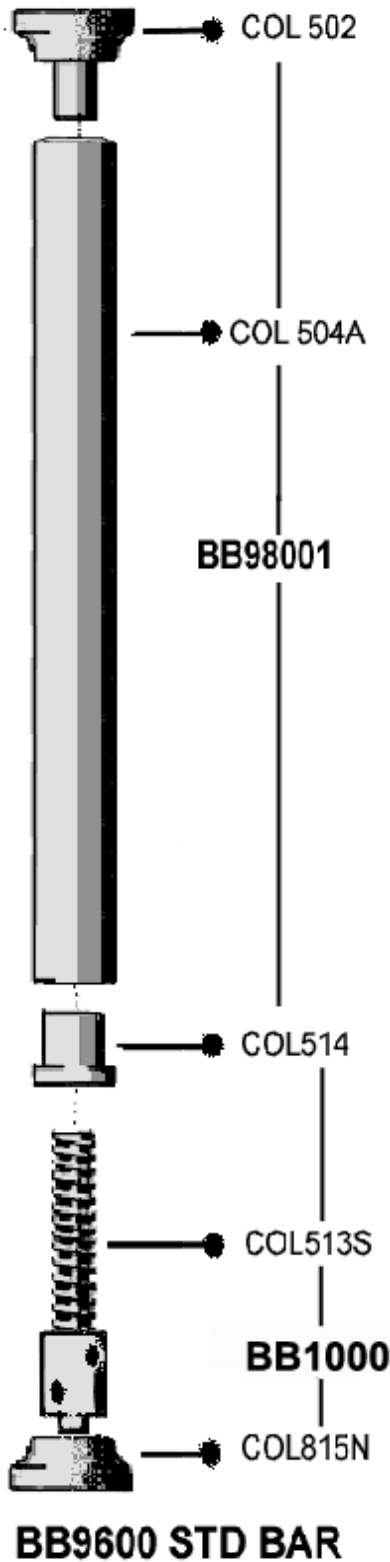

Column Bar Clamps

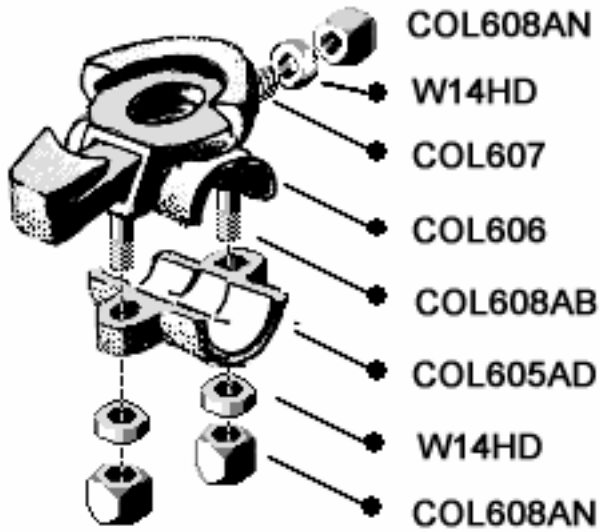

COL606X
Swing Dump Clamp Assembly

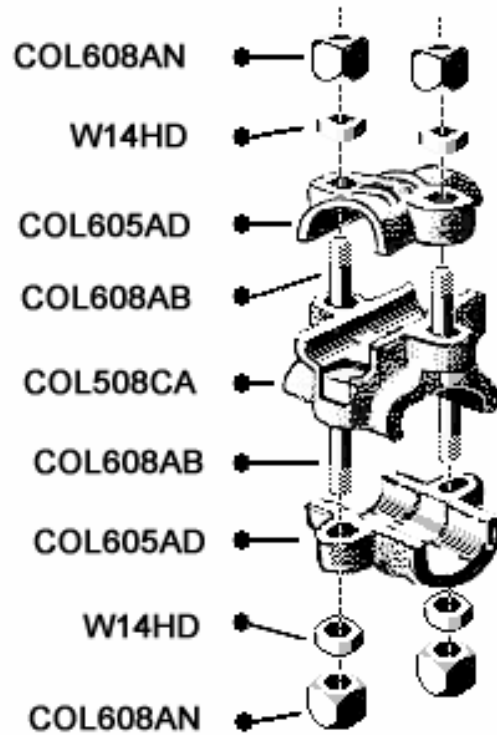

COL608CAX
Universal Clamp Assembly

MANUFACTURED TOUGH!

Parts HeadQuarters column clamps are machined from quality cast steel. The bolts are of grade two steel, and the nuts and the washers are made from higher quality, casehardening, steel for long life. Our tough column parts have been in use in Canadian Mining for over forty years and have proven the most durable and reliable column bar equipment that is available for mounting percussion type long-hole drills and pneumatic diamond drills.